

CS1105

Countryside II Villas- CS1105

 Frenaros, Famagusta

€330,000 +VAT





This e-mail and any attachments contained herein are privileged and confidential, intended only for the use of the recipient(s). If you are not the intended recipient of this email, you are hereby notified that any dissemination, disclosure, copying or use of information contained in this e-mail is strictly prohibited. If

Overview

Specifications

Bedrooms



3

Bathrooms



2

Covered



155.8 m²

Type	Detached Villa
Toilets	1
Plot	256 m²
Uncovered veranda	30 m²

Covered parking	22 m²
Status	Off plan
Year of construction	2026
Energy efficiency rating	A+

Description

Countryside II is an exclusive development of 7 modern villas located in the peaceful rural surroundings of Frenaros, just a short distance from the village centre and all everyday amenities. Designed for comfortable family living, this charming project combines privacy, space, and the relaxed lifestyle of a traditional Cypriot village.

Each villa offers 140 m² of internal covered areas, with spacious layouts carefully designed to meet modern living needs. The homes feature 3 well-sized bedrooms, 2 bathrooms, and 2 guest toilets, providing practicality and comfort for both residents and visitors.

Set on generous plots ranging from 220 m² to 257 m², Countryside II offers private outdoor space ideal for gardens, entertaining areas, or enjoying the tranquil surroundings.

Perfect for permanent residence, holiday living, or investment, Countryside II presents a unique opportunity to own a stylish home in a quiet location while remaining close to nearby towns and the beautiful east coast beaches of Cyprus.



Floor plans

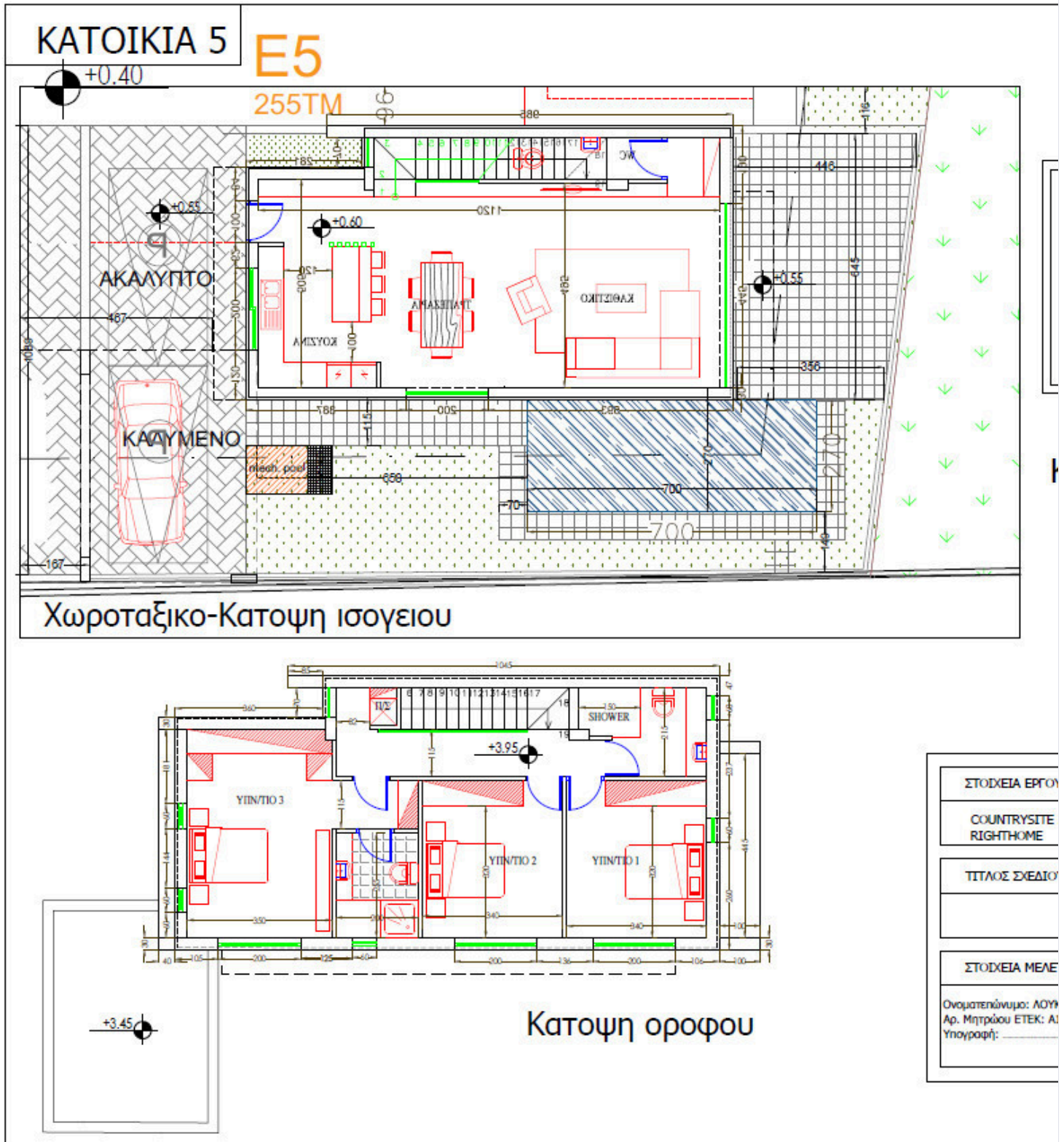

Additional information

Facilities

Aircondition, Provision
Solar water heater

Parking, Uncovered
Storage

Pool, Optional

Features

Central TV system
Distressed property
Fitted wardrobes
High ceilings
Modern design
Quiet area
Tile flooring

Connected to electric mains
Double glazing
Granite countertops
Internal stairs
Open plan
Sound insulation

Country view
Energy efficient doors/windows
Guest WC
Luxury specifications
Pipe-in-pipe plumbing system
Thermal insulation

Distances

Amenities

 300 m

Airport

 38 km

Sea

 8 km

Public transport

 300 m

Schools

 800 m

